

The camera consumes too much power.

Solution:

- 1 Adjust the position of the solar panel to receive more sunlight
- 2 Adjust the monitoring position of the camera to avoid the place where a large number of people go in and out
- 3 Reduce the sensitivity of the camera: setting --- smart detection --- motion detection sensitivity select the "low "level

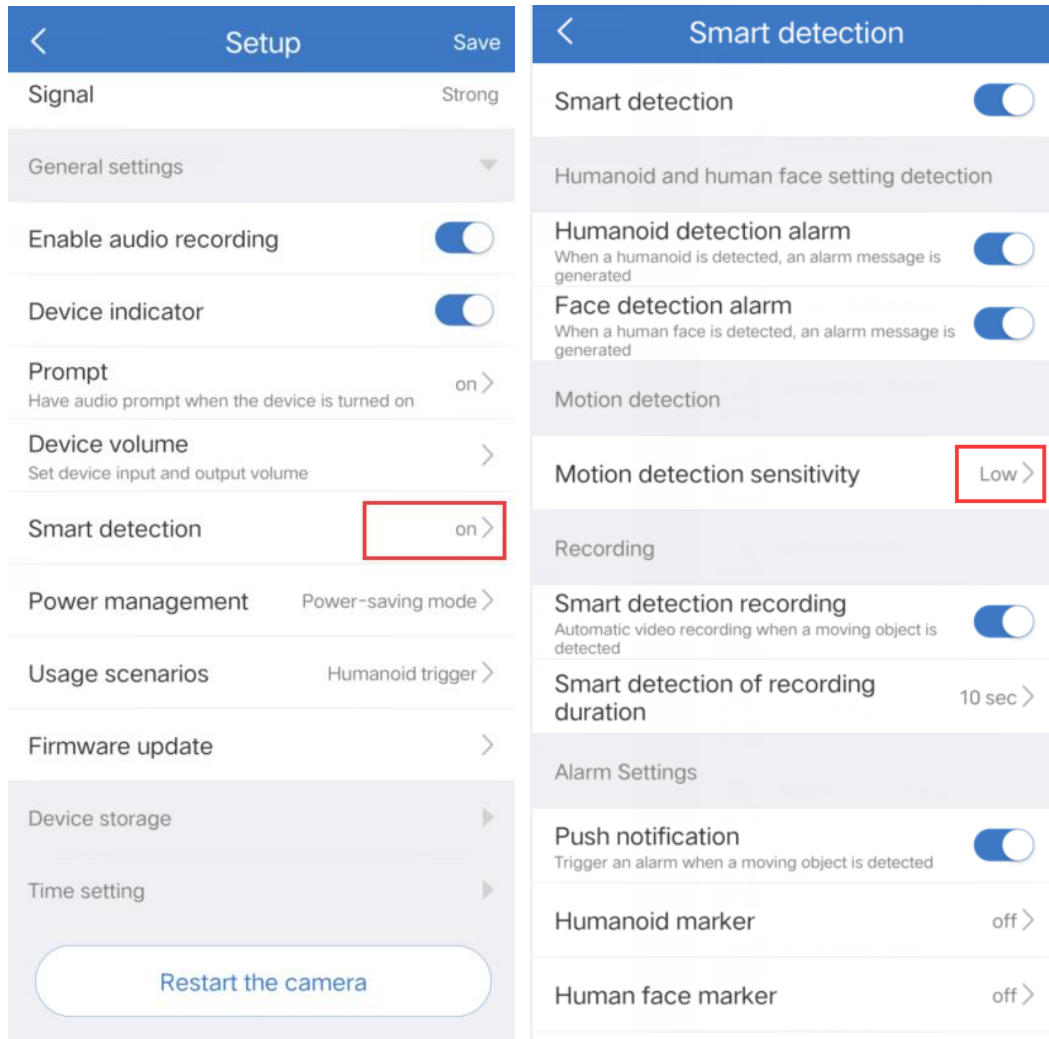

4 Select the shortest recording duration: setting --- smart detection --- smart detection recording "10 sec".

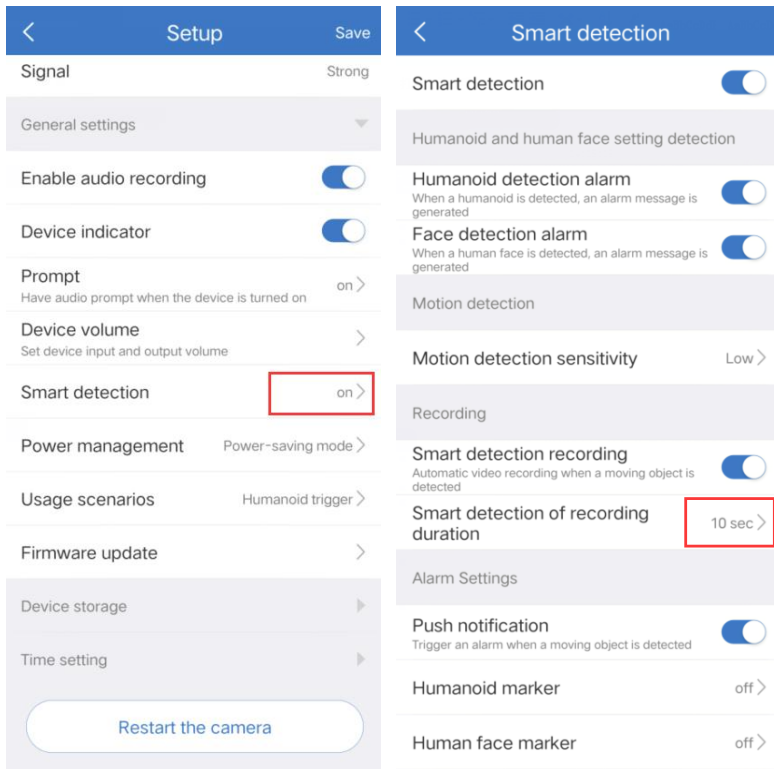

5 Select the mode with lower power consumption: setting --- power management select "power-saving mode"

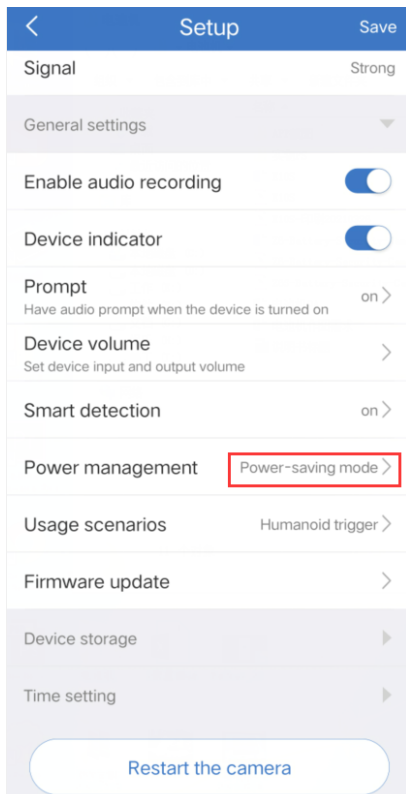

6 The alarm is triggered only when people are detected, but not when moving objects are detected: setting --- usage scenarios select "Humanoid trigger" .



7 Connect it to a cell phone power adapter all the time.